

# Patol Limited

Rectory Road  
Padworth Common  
Berkshire  
RG7 4JD

Tel: (0118) 9 701701  
Fax: (0118) 9 701700  
E-mail: [info@patol.co.uk](mailto:info@patol.co.uk)  
Web site: [www.patol.co.uk](http://www.patol.co.uk)

## Warehouse Racking

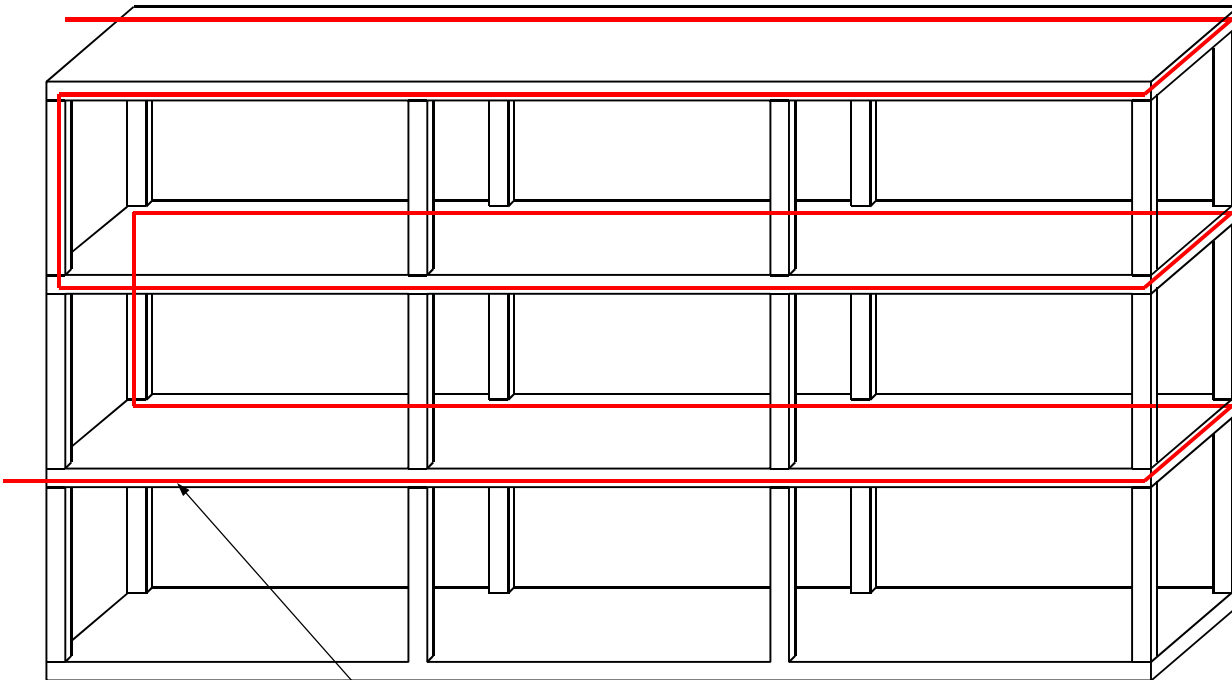

LHDC runs around the perimeter of the inside of each shelf/palette support. This protects against fire on the shelf below.

A risk associated with high density storage systems is that after only a few minutes of fire the metal racking potentially heats sufficiently to warp and collapse. This can then set off a “domino effect” with adjacent racks, causing loss of the entire stock and the risk of serious injury to anyone in the vicinity. Therefore, early fire detection is essential. By running Patol’s LHDC around the inside edge of every shelf/palette support a fire can be rapidly detected, allowing time to take corrective action. By mounting the LHDC in this location, damage to the cable caused by a palette or stock is minimized.

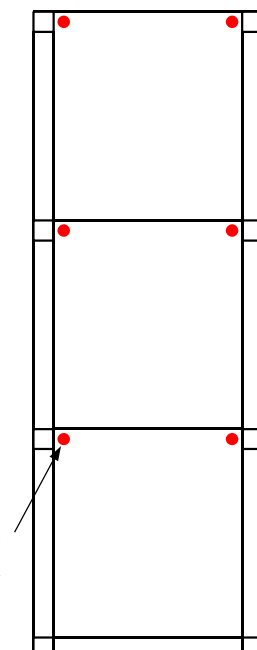

Cross section of the rack showing how the cable is protected from damage by locating it behind the shelf/palette supports.